



**Integra
Transform®**

Innovating
for
Performance

A vision made real by  **Integra
Systems**

ERGONOMIC WORKSTATIONS

Stand up for your health and improve productivity with **WorkSMART**



CONTACT US

Phone: +61 3 9359 3133

Email: integratransform@integrasystems.com.au

Visit: www.integratransform.com.au



Winner of the Tech
Leader Award
2021 KPMG Circular
Advantage Program



Inducted into the 2022
Victorian
Manufacturing Hall of
Fame

WORKSMART COLLECTION

Product Catalogue

Integra Systems, established in 1991, is a 100% Australian-owned industrial product design and advanced manufacturing enterprise in Melbourne's North, centered around light metal. With a motto to 'Make Your Vision Real', Integra turns customer concepts into fully resolved designs that can then be produced in Integra's advanced facility.

Our depth of knowledge in product development, circularity and market dynamics means we've become an incubation hub for inspirational ideas transformed into performance and circular-focused products. So, we decided to create our own collection of innovations designed to enhance business performance under our proprietary division - Integra TransForm. The **WorkSMART** products form part of this range.

Whether you are working from home, in the office or within an industrial setting, the ergonomic designs of WorkSMART empower you with more advanced, healthier practices for completing daily tasks.

CUSTOMISABLE

We pride ourselves in being part of a new breed of nimble Australian manufacturers, offering the option to customise our standard range of products.

CIRCULAR

We are passionate about an integrated approach to sustainability. Our world-class advanced manufacturing centres around the principles of the circular economy.

AUSTRALIAN-MADE

Our team embodies leadership and commitment, and bears the responsibility for establishing, implementing, integrating and maintaining our ISO 9001 Quality Management System.



THE AEROSMART PRO

Electric Height-Adjustable Workstation

STAND UP FOR YOUR HEALTH

Smooth and quiet height-adjustability at the press of a button, the **AeroSMART Pro** is made from Australian steel and manufactured with advanced Industry 4.0 technology at Integra Systems.

MOTOR

- World-class electronics by LINAK
- Dual linear actuator
- PIEZO™ controlled anti-collision technology
- Count calories and be alerted to stand
- 4 pre-set memory heights control box

HEIGHT RANGE

Minimum: 625mm lowered
Maximum: 1290mm raised

LOAD

Max loading: 120kg
Assembled weight: 60kg



Available in a range of sizes, colours and top options



ADD-ONS & UPGRADES

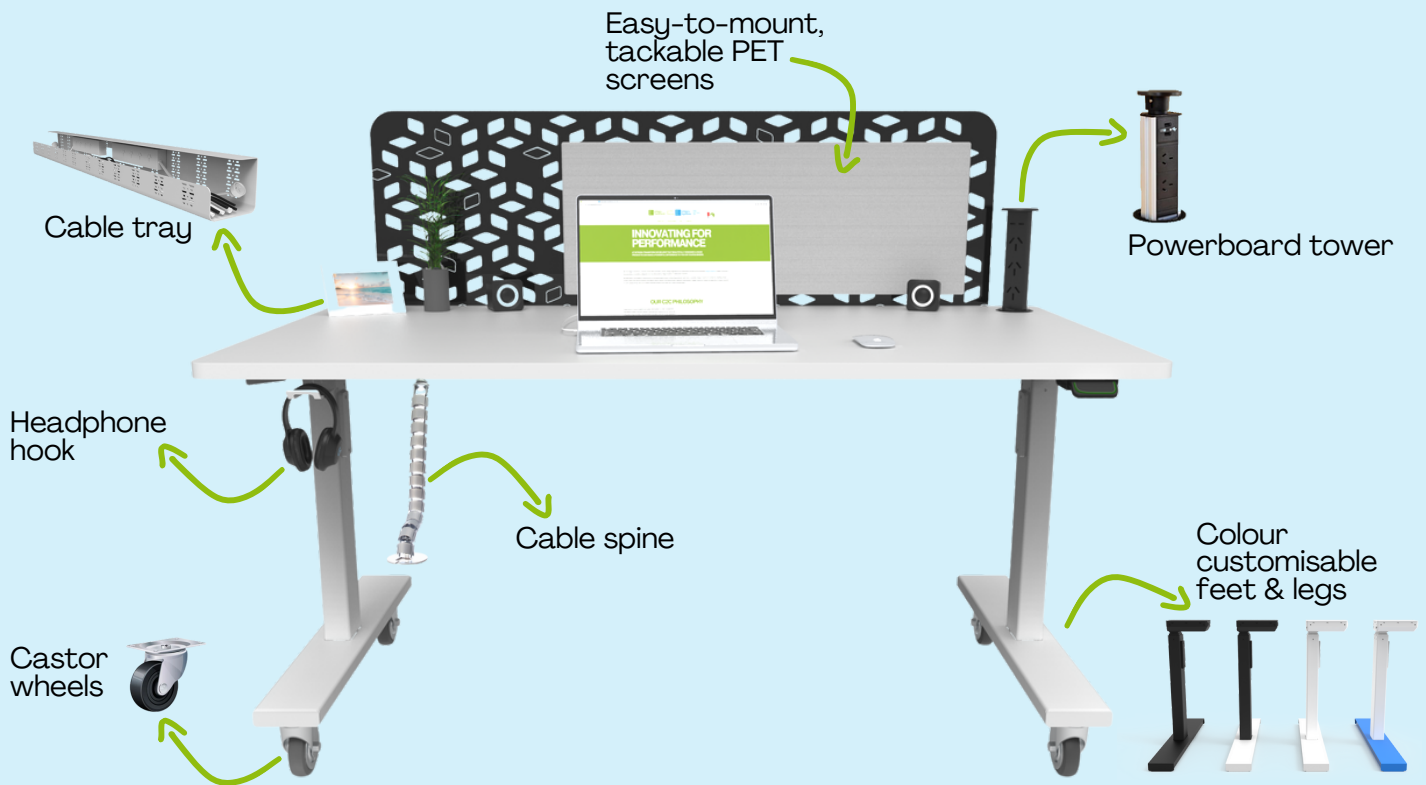

PRIVACY SCREENS

The AeroSMART Pro Privacy Screens have been carefully punched to achieve a smart design. Created from Australian powdercoated steel and available in various sizes, colours and patterns.

SIZES

Curved: H900mm

Flat: H320mm, H500mm, H900mm

Modesty: H320mm

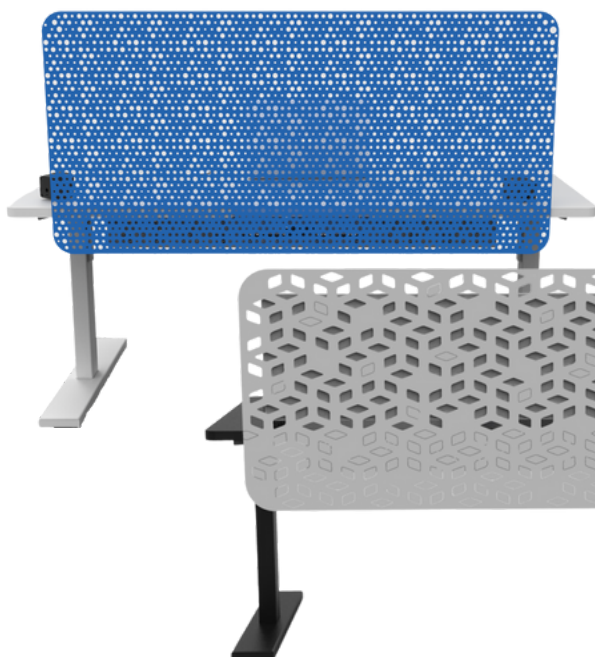

THE AEROSMART STEM

Training Simulator / Gaming Station

STAND UP FOR YOUR HEALTH

The sturdy and robust **AeroSMART STEM** features an all-inclusive package. It is the ideal workstation for a variety of settings including school and in the home, and can be used across many industry sectors such as defence, health and so on.

MOTOR

- World-class electronics by LINAK
- Dual linear actuator
- PIEZO™ controlled anti-collision technology
- Count calories and be alerted to stand
- 4 pre-set memory heights control box

HEIGHT RANGE

Minimum: 625mm lowered
Maximum: 1290mm raised

LOAD

Max loading: 120kg
Assembled weight: 60kg



OPTIONS:

Fixed AeroSMART STEM
Height-Adjustable AeroSMART STEM



INCLUSIVE PACKAGE

- USB hub
- Cable basket
- Powerboard
- Keyboard shelf
- Headphone hook
- Reinforced steel support for accessories to be mounted & dismantled

THE AEROSMART INDUSTRIAL

Electric Height-Adjustable Workstation

STAND UP FOR YOUR HEALTH

Designed to adapt to you, the **AeroSMART Industrial** features strong & sturdy construction that will lift your productivity to new heights. The AeroSMART Industrial is the ergonomic solution for home or in any workplace.

MOTOR

- World-class electronics by LINAK
- Dual linear actuator (single legs)
- Quad linear actuator (double legs)
- PIEZO™ controlled anti-collision technology
- Count calories and be alerted to stand
- 4 pre-set memory heights control box

HEIGHT RANGE

Minimum: 625mm lowered
Maximum: 1290mm raised



Base Model

Max. loading 240Kg



Single Legs

Ideal for precision
Max. loading 120Kg



Twin Legs

Ideal for heavy work
Max. loading 240Kg

ADD-ONS & UPGRADES



THE BIOSMART PRO

Electric Height-Adjustable Converter

STAND UP FOR YOUR HEALTH

Experience the benefits of an ergonomic workspace while capitalising on your existing furniture assets. Transition from sitting to standing at the push of a button with our **BioSMART Pro**.

MOTOR

- World-class electronics by LINAK
- PIEZO™ controlled anti-collision technology
- Count calories and be alerted to stand

HEIGHT

Single - Triple Monitor Pole

Minimum: 535mm lowered Maximum: 1195mm raised

Quad - Hex Monitor Pole

Minimum: 870mm lowered Maximum: 1530mm raised

ASSEMBLED DIMENSIONS

780mm (w) x 500mm (d) 560mm stroke

SCREEN MOUNT SPECIFICATIONS

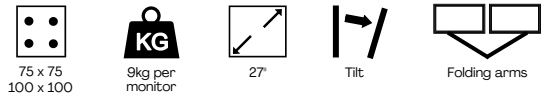

GO FROM SITTING TO STANDING AT THE PRESS OF A BUTTON

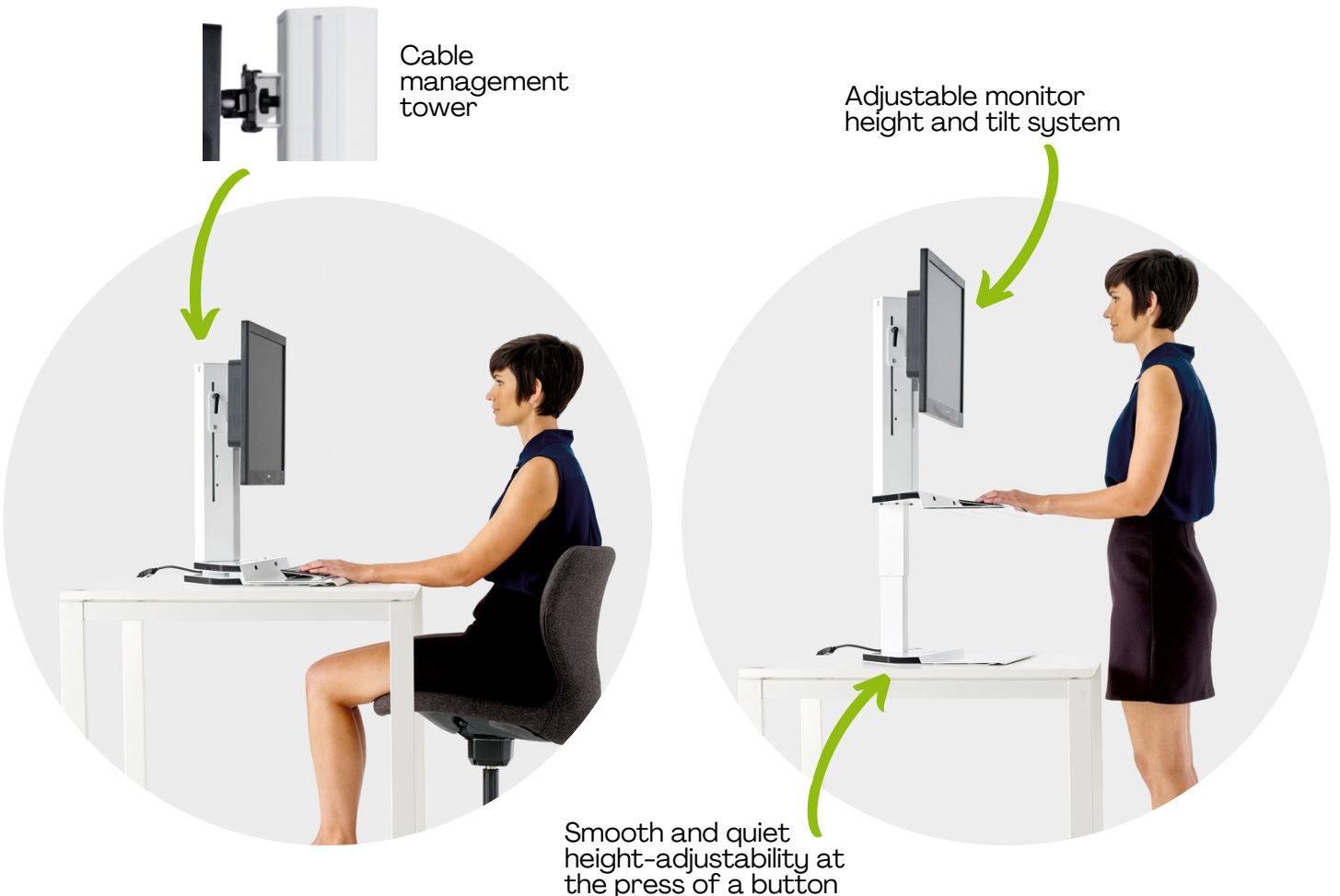

MONITOR OPTIONS



SINGLE MONITOR



DOUBLE MONITOR



SINGLE + LAPTOP TRAY



TRIPLE MONITOR



QUAD MONITOR



HEX MONITOR

THE BIOSMART MOBILE

Height-Adjustable Mobile Workstation

STAND UP FOR YOUR HEALTH

The **BioSMART Mobile** features an adjustable monitor for perfect elbow-to-eye height, electric height-adjustability at the press of a button and a sturdy ergonomic lowered keyboard tray. Have the freedom to work where you need to, and at just the right height, perfect for industrial, medical and commercial settings.

MOTOR

- World-class electronics by LINAK
- PIEZO™ controlled anti-collision technology
- Count calories and be alerted to stand

HEIGHT RANGE

Minimum: 1470mm lowered
 Maximum: 2460mm raised

LOAD

Assembled weight: 54 - 61 kg

SCREEN MOUNT SPECIFICATIONS

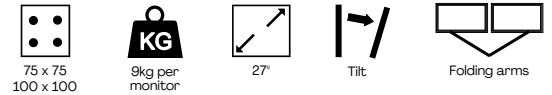

TAKE YOUR WORKSPACE WITH YOU ANYWHERE

Options

MONITOR:

Single, Double or Single + Laptop Tray

COLOURS:

White or Black

MONITOR OPTIONS



SINGLE MONITOR



DOUBLE MONITOR



SINGLE + LAPTOP TRAY





**Integra
Transform®**

Innovating
for
Performance

A vision made real by  **Integra
Systems**



CONTACT US

Phone: +61 3 9359 3133

Email: integratransform@integrasytems.com.au

Visit: www.integratransform.com.au



Winner of the Tech
Leader Award
2021 KPMG Circular
Advantage Program



Inducted into the 2022
Victorian
Manufacturing Hall of
Fame

WORKSMART COLLECTION